



New MX - Series

MX3200 and MX5200, new economical high - speed overlock machine



Pegasus is introducing the new economical and high-speed overlock machine, MX3200 and MX5200.

This new developed economical - high - speed machine is capable of a speed of up to **8000** rpm and ensures high productivity.

MX-series offers basically almost the same features like EX-Series with additional and **outstanding new technical points:**

- direct needle bar drive for smoother running and reduced wear
- direct feed bar drive, reducing overthrow to a minimum and

avoiding a change in stitch length between changing machine speeds

- needle thread take-up like EX style
- knife drive mechanism like EX, avoiding push back of fabric
- all gauge parts of EX are interchangeable with MX
- shape of loopers are the same as EX, reducing wear and tear and improving stitch formation
- built in link for the presser bar mechanism (movable) reducing and / or preventing ply shift **NEW**

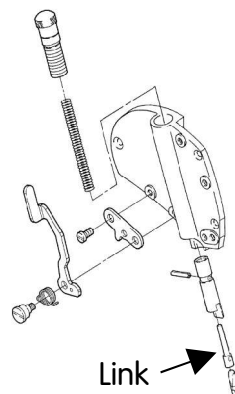

- additional rubber cushion between cloth plate and machine bed to avoid vibrations **NEW**

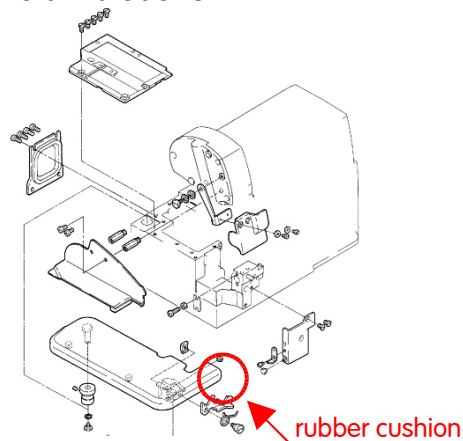

- mechanism to change the position of the presser arm shaft, i. e. the position of the centre of the rotation axis can be changed, according to woven or knitted fabric. **NEW**



Upper supporting position for knit fabrics



Lower supporting position for woven fabric

- forced draining system on the needle bar
- forced draining system on the upper looper shaft **NEW**

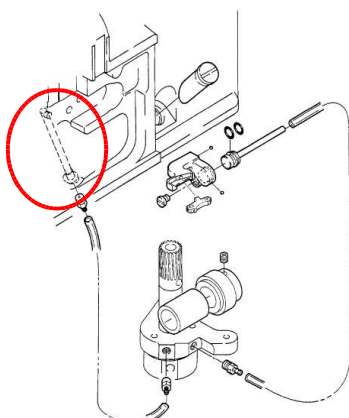

- the needle bar is totally enclosed **NEW**



- 3 oil seals on feed bar **NEW**

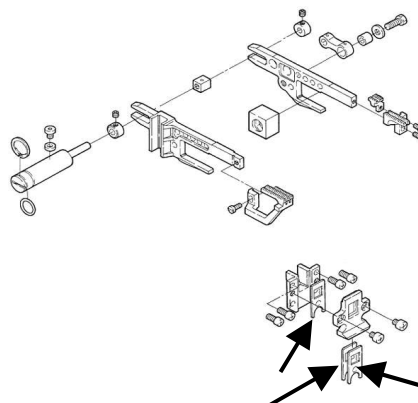

- gasket for oil reservoir and top cover, has improved shape, increasing sealing points to 7 **NEW**



- many more common and well known features are adapted to the new MX – series.

The MX – series offers a maximum of today's technology to our customers and has some remarkable features, which our competitors can not offer.

Available Subclasses:

Safety stitch machines

Plain seaming of light to medium weight fabric
MX3216-02/233-3x4
Plain seaming of medium to heavy weight fabric
MX3216-03/333-5x5
Plain seaming of extra heavy weight fabric
MX3216-A04/435-5x6
Plain seaming of medium to heavy weight fabric
MX3244-03/333-3x2x4
Shirring operations on light to medium weight fabric
MX3216-42/233-3x4
Shirring and piping operations on light to medium weight fabric
MX3216-42P2/233-3x4

Overlock machines

Plain seaming of light to medium weight fabric
MX5204-02/233-4
Plain seaming of medium to heavy weight fabric
MX5214-M03/333-2x4
Plain seaming of medium to heavy weight fabric and inserting stabilising tape
MX5214-M53/333-2x4
Plain seaming of heavy to extra heavy weight fabric and inserting stabilising tape
MX5214-M54/433-2x4
Turn down hemming of light to medium weight fabric
MX5204-32R2/223-1,5
Plain seaming of light to medium weight fabric and blind stitch hemming
MX5204-02H/223-4
Blind stitch hemming of light to medium weight fabric
MX5205-12/223-4

Manual back latching
MX5204-82/233-4/BT ***
MX5214-83/333-2x4/BT ***

*** = to be introduced later

For further details of subclass relevant specifications, please refer to the appended table of "MX – series subclass specifications".



EX2241-02/083 as replacement for E22-720/401-293

The new subclass of single needle double chain stitch machine was introduced as a replacement for model E22-720.

The gauge parts of the new EX2241-02 are identical.

This new model can also be used together with E22L – left hand machine.

This machine is available ex stock PE.



Following TK – devices are now available for W1500 – series:

W1562-02Gx356· 364BS&CT/TK1C:
Operated by [electric cutter with knee switch](#)

W1562-02Gx356· 364BS&CT/TK3C:
Operated by [air cutter with knee switch](#)

W1562-05Bx356· 364BS&CT/FT0B/
MD0A/TK3C:
Operated by [air cutter with knee switch](#)

Please include these models in your offers to your customers.

MX Series subclass specifications Technische Daten für die Unterklassen der Baureihe MX

MX3200

用途 Application Verwendungszweck	生地の厚さ Fabric weight Stoffgewicht	サブクラス Subclass Unterklasse	針数 (本) Number of needles Anzahl der Nadeln	糸数 (本) Number of threads Anzahl der Fäden	針幅 Needle space Nadelabstand (mm)	かがり幅 Overedge width Überstichbreite (mm)	縫い目長さ Stitch length Stichlänge (mm)	差動比 Diff. feed ratio Differential-transport-verhältnis	押工上がり量 Presser foot lift Presserfußhub (mm)	最高回転数 Max. speed Max. Drehzahl (r.p.m.)
地縫い Plain seaming Allgemeine Näharbeiten	薄～中厚 Light — Medium Leicht — Mittelschwer	MX3216-02/223	2	5	3	4	0.6 - 3.8	0.7 - 2	5	7,500
	中厚～厚 Medium — Heavy Mittelschwer — Schwer	MX3216-03/333	2	5	3 5	4 5	0.6 - 3.8	0.7 - 2	5.5	7,000
	極厚(デニム) Extra heavy (denim) Sehr schwer (Jeansstoff)	MX3216-A04/435	2	5	5	6	0.8 - 5	0.8 - 1.5	7	6,500
	中厚～厚 Medium — Heavy Mittelschwer — Schwer	MX3244-03/333	3	6	3×2	4	0.6 - 3.8	0.7 - 2	5.5	7,000
ヒダ取り Shirring Kräuseln	薄～中厚 Light — Medium Leicht — Mittelschwer	MX3216-42/233	2	5	3	4	0.6 - 3.2	0.85 - 2.8	5	7,000
ヒダ取りパイピング Shirring & Piping Kräuseln & Paspeln	薄～中厚 Light — Medium Leicht — Mittelschwer	MX3216-42P2/233	2	5	3	4	0.6 - 3.2	0.85 - 2.8	5	7,000

MX5200

地縫い Plain seaming Allgemeine Näharbeiten	薄～中厚 Light — Medium Leicht — Mittelschwer	MX5204-02/233	1	3	—	4	0.6 - 3.8	0.7 - 2	5	8,000
	中厚～厚 Medium — Heavy Mittelschwer — Schwer	MX5214-M03/333	2	4	2	4	0.6 - 3.8	0.7 - 2	5.5	7,500
巻き縫い Turn-down hemming Nach unten umgeschlagene Säume (Rollsaum)	薄～中厚 Light — Medium Leicht — Mittelschwer	MX5204-32R2/223L	1	3	—	1.5	0.6 - 3.2	0.7 - 2	5	8,000
テープ付け Inserting tape Band einnähen	中厚～厚 Medium — Heavy Mittelschwer — Schwer	MX5214-M53/333	2	4	2	4	0.6 - 3.2	0.7 - 2.4	5.5	7,500
地縫い・裾引き Plain seaming/ Blindstitch hemming Allgemeine Näharbeiten/ Blindstichsäumen	薄～中厚 Light — Medium Leicht — Mittelschwer	MX5204-02H/223	1	3	—	4	0.6 - 3.8	0.7 - 2	5.5	8,000
裾引き Blindstitch hemming Blindstichsäumen	薄～中厚 Light — Medium Leicht — Mittelschwer	MX5205-12/223	1	3	—	4	0.6 - 3.8	0.7 - 2	5.5	8,000
テープ付け Inserting tape Band einnähen	厚～極厚 Heavy — Extra heavy Schwer — Sehr Schwer	MX5214-54/443	2	4	2	4	0.6 - 2.4	1.1 - 3.8	7	6,500
バックタック Backclatching Nahtanfangsverriegelung	薄～中厚 Light — Medium Leicht — Mittelschwer	MX5204-82/233	1	3	—	4	0.6 - 3.8	0.7 - 2	4.5	8,000
	中厚～厚 Medium — Heavy Mittelschwer — Schwer	MX5214-83/323	2	4	2	4	0.6 - 3.8	0.7 - 2	5.5	7,500

縫目形式 Stitch type Stichtyp	504, 505, 514, 516, 514+401
使用針 Needle size Nadelgröße	DC×27 #9, 11, 14, 21
本体寸法 Machine size Maschinenabmessung	W : 370mm D : 285mm H : 300mm

乾燥重量 Net weight (head only) Nettogewicht (nur Maschinenoberteil)	27kg
総重量 Gross weight (with accessories) Bruttogewicht (mit Zubehör)	35kg
騒音値 Working noise level Geräuschpegel beim Betrieb	n=7,200r.p.m. : LpA ≤ 84.7dB(A) DIN 45635 48A-1 準拠 Noise measurement according to DIN 45635 48A-1 Geräuschmessung gemäß DIN 45635 48A-1