

E - Left - Series

Please note following printing error:

In the parts catalogue-no. 9550,
on page 7, item 23
parts # 211109 must be
parts # 211119 hinge (front cover)
Please correct it in your files and inform
all persons concerned to avoid any
wrong orders in future.
Thank you for your kind attention.

Please, also correct following on E- left, page 6:

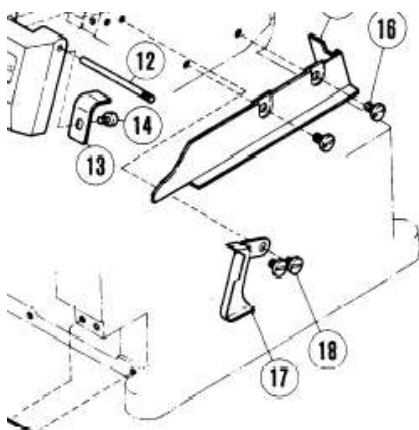

Item (17) with parts no 211109 is correct
and item (23) with parts no 211109 has
to be changed to parts no.
211311 in case of E22L and
21174 in case of E32L

Please inform all persons concerned
and thank you for your kind attention.

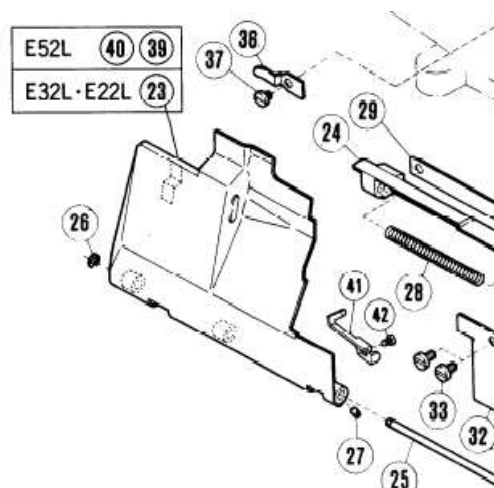

W2600 - Stitchlock

With immediate effect is the stitchlock
device available for W2600 – Series.
The stitchlock device is registered as
following subclass:

- 1) **SL3J** = **Stitchlock device** with UT3J,
(pneumatic thread trimmer
including pneumatic thread
wiper)
- 2) **SL4M** = **Stitchlock device** with UT4M,
(pneumatic thread trimmer
with top cover thread
trimmer, without thread
wiper)

We are looking forward to receiving your
orders.